



General shipping information

Determination of tumor cell numbers & Therapy-related properties

- *Lab request form*
(completely filled, signature of the patient)
- *15 ml EDTA blood*
(blood tubes labeled with patient name, date of birth and sample date)

Drug testing

- *Please send a daily dose of the medication or alternative remedy after consultation with our medical laboratory.*
- *Lab request form*
(completely filled, signature of the patient)
- *15 ml EDTA blood*
(sufficient for the testing of up to 7 medications,
blood tubes labeled with patient name, date of birth and sample date)

Testing & Results

- *Please send the samples immediately after blood collection.*
- *Ship the samples via courier (i.e. GO!, FedEx or DHL).*
- *Results will usually be available 5 days after receiving the sample and will be forwarded to you via digital result box or postal service.*
- *If you have medical questions, please get in touch with our medical laboratory: +49 (0) 921 850 200.*

Further information can also be found online:
www.maintrac.com



Sample packaging

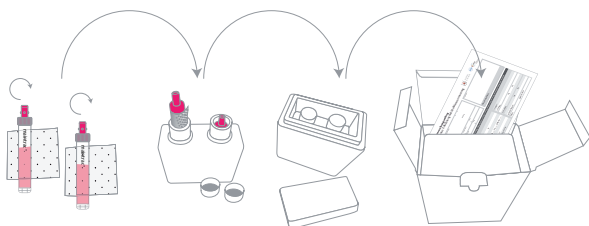

Procedure

- Wrap the enclosed **absorbent fleece** around the two 7,5ml EDTA blood tubes.
- Place the blood tubes together with the fleece in the **thermal element**; close the screw caps.
- Pack the thermal element in the **styrofoam container**.
- Put the styrofoam container in the **cardboard** and enclose the filled-in lab request form as well as the medical history.
- Package should be sent to the following address:
Labor Dr. Pachmann
Kurpromenade 2
95448 Bayreuth, Germany
- You can use our pickup request form to send the blood samples with GO! .
- The package has to arrive at our medical laboratory within **48 - 72 hours**.
- **Storage and shipping at room temperature (DO NOT COOL OR FREEZE)**

Specialized Medical Laboratory

Dr. Pachmann

Kurpromenade 2
95448 Bayreuth, Germany
Telefon: +49 (0) 921 850200



maintrac has been performed by the DIN EN ISO 15189 accredited Specialized Medical Laboratory Dr. Pachmann since 2005.